

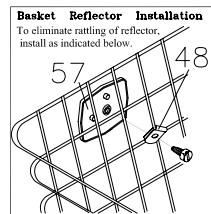

Trailmate

DOUBLE JOY RIDER ILLUSTRATED PARTS BREAKDOWN

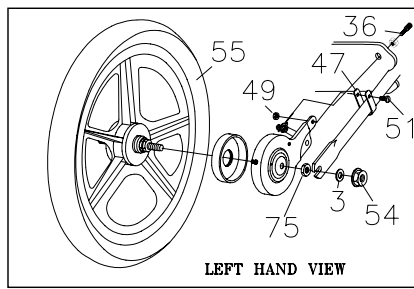
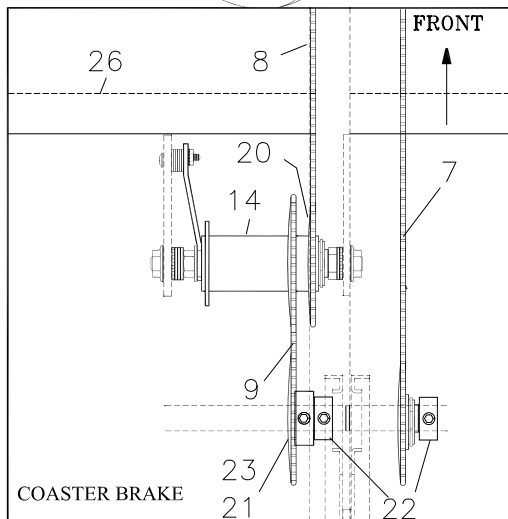
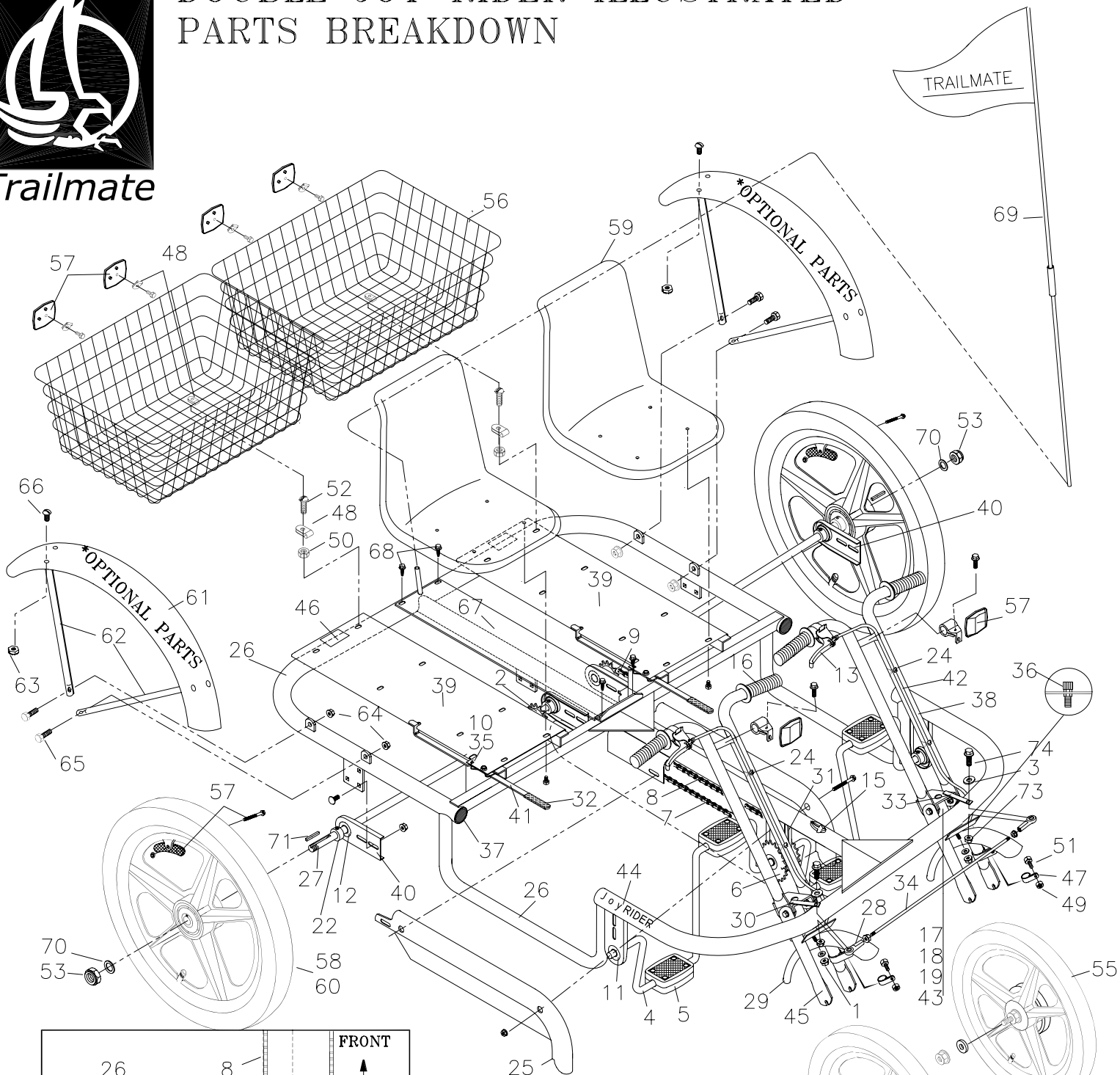

Ref #11355
06/19/06

**DOUBLE JOY RIDER
PART LIST.**

ITEM NO.	PART NO	DESCRIPTION	QTY.	ITEM NO.	PART NO	DESCRIPTION	QTY.
1	11073	NUT 3/8-16 SIDE LOCK	2	37	18196	PLUG TUBE 1-1/2"ID TAPERED 15S	4
2	11949	FREEWHEEL 22T & ADAPTER ASSY	1	38	18210	HANDLEBAR ASSY JR/DJ ST COLOR	2
3	12301	WASHER 3/8 FLAT SAE	6	39	18216	BASE JR/DJ SEAT/BASKET ST COLR	2
4	18287	CRANK JOY RIDER/DJ PLATED	2	40	18220	AXLE BEARING HLD RR JR/JUNR/DJ	5
5	19181	PEDAL HALF JOY RIDER	8	41	18221	LEVER SEAT ADJ JR/DJ ST COLOR	2
6	19361	SPROCKET 32T W/ADAPTER	2	42	18227	BRAKE CABLE JR/JUNR/DJ 34X42	2
7	19391	CHAIN/CL 161 PITCH JR/DJ FW	1	43	18265	FORK BEARING HLDR LWR JR/ JUNR/DJ	2
8	19392	CHAIN/CL JR LONG 119 PITCH	1	44	18335	DECAL JOY RIDER/DOUBLE JOY	2
9	19393	CHAIN/CL JR SHORT 61 PITCH	1	45	18337	FORK JOY RIDER/DJ STATE COLOR	2
10	11061	NUT 1/4-20 NYLON INSERT	2	46	19325	DECAL "DO NOT STAND ON CYCLE"	2
11	11642	BEARING AXLE 5/8" ASF 107E	4	47	19156	BAND BRAKE ARM STRAP	2
12	11643	BEARING SP 99502HNR	4	48	12069	BASKET HOLD DOWN	12
13	11654	BRAKE CALIPER LOCK LEVER ALLOY	2	49	12170	NUT 10-32 HEX KEPS	2
14	11667	HUB CB TRIKE SHIMANO	1	50	12172	NUT 1/4-20 FLANGED	8
15	11718	DECAL TM HEAD	1	51	12193	SCREW 10-32X1 PHIL PAN HD MS	2
16	11801	GRIP BLACK 7/8 #40-0203-055	4	52	16699	SCREW 1/4-20X5/8 FLNGE HD	8
17	11821	HEAD BEARING	4	53	19720	NUT 5/8-18 NYLON INSERT	2
18	11827	HEAD LWR FORK STATIONARY CONE	4	54	19002	NUT 3/8-24 FLANGED	4
19	11830	HEAD CUPS #401B	4	55	11078	WHL 12.5 W/TIRE, TUBE & BRAKE	2
20	11939	SPROCKET 21T CB SHIMANO	1	56	11639	BASKET COATED TRIKE #1275WH	2
21	11952	SPROCKET 22T SOLID W/ADAPTER	1	57	11871	REFLECTOR KIT TRIKE	2
22	12241	SET COLLAR 5/8"	6	58	11961	TIRE 24X1.75 BSW W/TUBE	2
23	12246	KEY SQUARE 3/16X5/8	4	59	18206	SEAT JOY RIDER/DJ WD140LS710	2
24	12269	TIE CABLE BLACK 8X.18	4	60	18239	WHL 24X1.75 MAG TRIKE REAR WHT	2
25	13860	CHAINGUARD DOUBLE JOY	2	61*	11748	FENDER 24" MWT TRIKE REAR	2
26	13861	FRAME DOUBLE JOY	1	62*	18306	BRACE REAR FENDER JR/BP	4
27	20016	AXLE REAR DOUBLE JOY	2	63*	12170	NUT 10-32 HEX KEPS	8
28	13900	BALL JOINT ROD END DBL JOY	2	64*	12175	NUT 5/16-18 FLANGED	4
29	13994	FENDER 12" FRNT JR/JUNR/DJ REV	2	65*	12208	SCREW 5/16-18X3/4 HHCS	4
30	16346	STEERING ARM RIGHT DOUBLE JOY	1	66*	19171	SCREW 10-32X3/8 RHMS	8
31	16353	SPACER PLATE BEARING HGR DJ	1	67	19732	CAINGUARD REAR DBL/JOY	1
32	17160	GRIP DEPTH CNTRL HNDL 3/8X2.25	2	68	12188	SCREW 10-32X3/8 SLTD HWH	4
33	17249	STEERING ARM LEFT DOUBL JOY	1	69	12102	SAFETY FLAG W/O BRACET	1
34	17251	TIE ROD DOUBLE JOY	1	70	12240	WASHER SPACER	7
35	17348	SPRING JR/JUNIOR/DJR/LATCH KEE	2	71	20012	KEY SQUARE 3/16X1-1/4	2
36	17851	BAND BRAKE BARREL & NUT ADJ	2	72	12215	SCREW 5/16-18X3/4 CARRIAGE	4
				73	12220	SCREW 3/8-16 X 1-3/4 HHCS	2
				74	12178	NUT 3/8-16 FLANGED	4
				75	13888	3/8-24 JAM NUT	1

*-OPTIONAL PARTS ONLY

06.19.06

DOUBLE JOY RIDER ASSEMBLY INSTRUCTIONS

TOOLS REQUIRED

3/8" Wrench	5/32" Allen wrench
1/2" Wrench	Common Screwdriver
9/16" Wrench	Phillips Screwdriver
1/2" Socket Wrench	Hammer
Adjustable Wrench	Air Pump
15/16" Wrench	Pliers

1. Preparation

Remove all parts from the frame and wheel cartons. Inflate (or have inflated) tires (55 and 58) to pressure recommended on sidewalls.

Make sure tires properly seated on the rims.

2. Rear Wheels

Lift up the rear of the frame assembly (26) and slide the rear wheels (60) onto the axles shaft.

Note: Wheel hub faces in.

Align wheel-axle keyways and tap 1-1/4" key square, (71), into keyway. Install washer (70), and secure the wheels on axle with 5/8" nylon lock nut (53).

Important: Make certain the axle thread fully engages the nylon locking portion of nut.

3. Front Wheels:

Place front wheels (55) and brake assembly between the fork with the axle bolts fully into the slots on the end of the fork. Secure with washers (3) and nuts (54). The brake arm must be on the left side and in front of the fork blade.

4. Hand Break

Loosen the lock nut on the brake cable bracket (at the front wheels). Push the brake cable bracket upward as much as you can while pulling as much cable as possible through the hole in the bolt. Be sure the brake cable is seated properly in the brake lever (13) and that the adjustable "barrel nut" (36) at the fork is protruding below the fork plate as far as possible. Secure the lock nut on the brake bracket to hold the cable in place. NOTE: The hand brake may require further adjusting before riding.

5. Seat

Position the seat (59) over the mounting holes in the base seat/basket (39). Insert screws into bottom of the seat and secure seat.

6. Basket

Position the basket (56) onto seat/basket base. Place the four basket brackets (48) over the basket wires and secure with the bolts (52) and flanged nuts (50).

8. Reflectors

Install the red reflectors on the back of the basket. Insert the screw provided with the reflector on the basket so the clip will capture the corner of the vertical and horizontal wires and tighten the screw. Repeat for the other side. The basket reflectors should be about one foot apart. Install clean reflector on each handle cross bar. Slide plastic holder on handle cross bar. Tighten with the screwdriver and install reflector. On plastic MAG wheels install reflectors on tabs using screw and nut.

9. Final Check

Install safety flag in holder. Review the instruction; check connecting bolts and screws for tightness, and readjust the seat and handlebar as necessary.

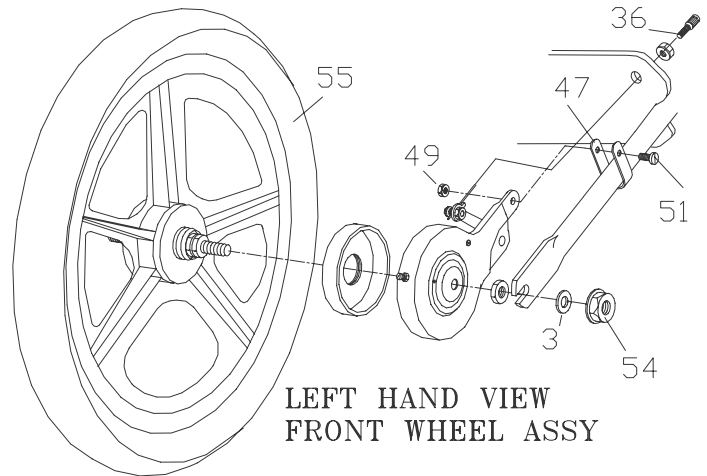

Basket Reflector Installation
To eliminate rattling of reflector,
install as indicated below.

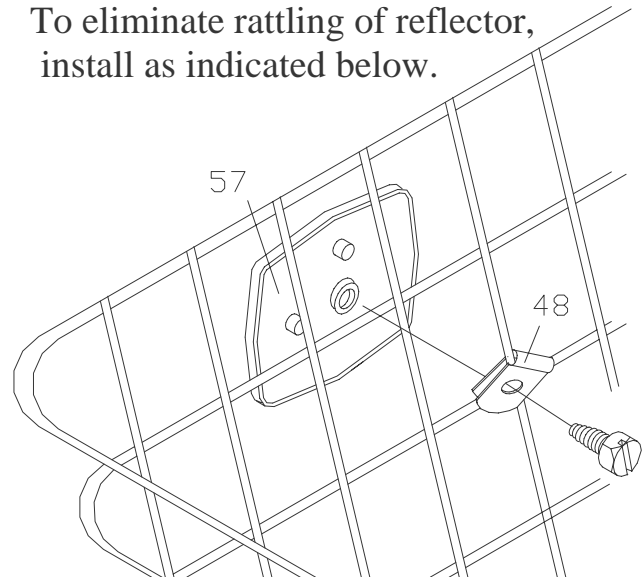

REGULAR MAINTENANCE: Bi-Monthly

1. Keep all painted parts cleaned and waxed for a long-lasting luster.
2. Lubricate the following:
 - Axle shafts
 - Chain-rotate pedal crank and spray freely with a good quality spray lubricant, wipe off any excess.
3. When storing over prolonged periods, turn upside down to prevent flats from occurring on the tires. If storing outside, cover to protect finish and moving parts.

PREVENTIVE MAINTENANCE: Every Six Months

These are services that should be performed by your local bicycle shop. A fee may be charged.

1. Check tires for wear, rim cuts and valve core alignment (usually caused by improper air pressure).
2. Check wheels for cracks and alignment.
3. Check brakes for proper operation.
4. Check and repack all bearings and adjust all cones.
5. Check for worn bearings, cones and cups.
6. Check chain for proper tension and clean as needed.
7. Check for loose bolts and nuts.

Attention: While your unit is new, some noises may occur during the break-in period. Should they continue for more than 30 days, see local bike shop.

INSPECTION

Check the following, as it applies to your cycle, on a regular basis:

1. Wheels: Check wheels for alignment.
2. Pedals: Inspect pedals and make sure pedals are tightly attached to crank.
3. Handle grips: Replace worn or loose grips.
4. Chain: Check for proper tightness. Replace damaged chain immediately.
5. Seat: Adjust seat for ride comfort and safety.
6. Tires: Keep tires inflated to the recommended tire pressure, as indicated on the tire's sidewall.
7. Frame: Replace damaged frame immediately.

Double Joy rider

This is a recreational unit, not designed for excessive speed or misuse.

Careless operation may cause rider to lose control and result in serious injury.

Do not brake or turn at high speeds; this may cause cycle roll-over and rider injury.

Things to know before riding your cycle:

1. Know your local bicycle laws and wear a helmet.
2. Do not exceed the recommended weight limit of 250 lbs. on one seat.
3. Do not stand on unit.
4. Wear light-colored clothing and protective gear.
5. Do not ride at night.



Trailmate

1851 67th AVE East

Sarasota, FL 34243

Tel: (941) 755-5511

Fax: (941) 758-5141

Visit us @ www.trailmate.com

**For service or to order
replacement parts
please contact your
local Trailmate dealer.**

DOUBLE JOY RIDER

This is a recreational unit, not designed for excessive speeds or misuse.

Do not brake or turn at high speeds. This may cause cycle to roll over. Careless operation may cause rider to lose control and result in **serious injury**.

Things to know before riding your cycle:

1. Know your local bicycle laws and wear a helmet.
2. Do not exceed the recommended weight limit of 250 lbs.
3. No more than one rider at one time.
4. Do not stand on unit.
5. Be sure to install safety flags.
6. Wear light-colored clothing and protective gear.
7. Do not ride at night.
8. Children must be supervised by an adult at all times.

Trailmate Limited Warranty

Trailmate, Inc., guarantees each cycle product against all defects in materials and workmanship for a period of 90 days from date of purchase. Tires and tubes are not covered by this guarantee.

During this period, any part that is judged by the makers to be defective will be replaced free of charge. Any failure resulting from accident, abuse, neglect, normal wear, or improper assembly or maintenance by the owner is not covered.

Trailmate, Inc., further authorizes a lifetime frame guarantee and will replace any frame, at no cost to the buyer, providing that item has not been used for rental use and that:

- 1) The item has not been altered, repaired, or modified in any way.
- 2) The item has not been subject to misuse, negligence, and/or an accident.
- 3) Original ownership is established.

Any parts under this guarantee on which claims are entered shall be returned for inspection with transportation charges prepaid by the claimant. Replacement parts will be shipped F.O.B. factory.

There are no warranties or guarantee, expressed or implied, written or oral, which extend beyond the description on the face hereof.