

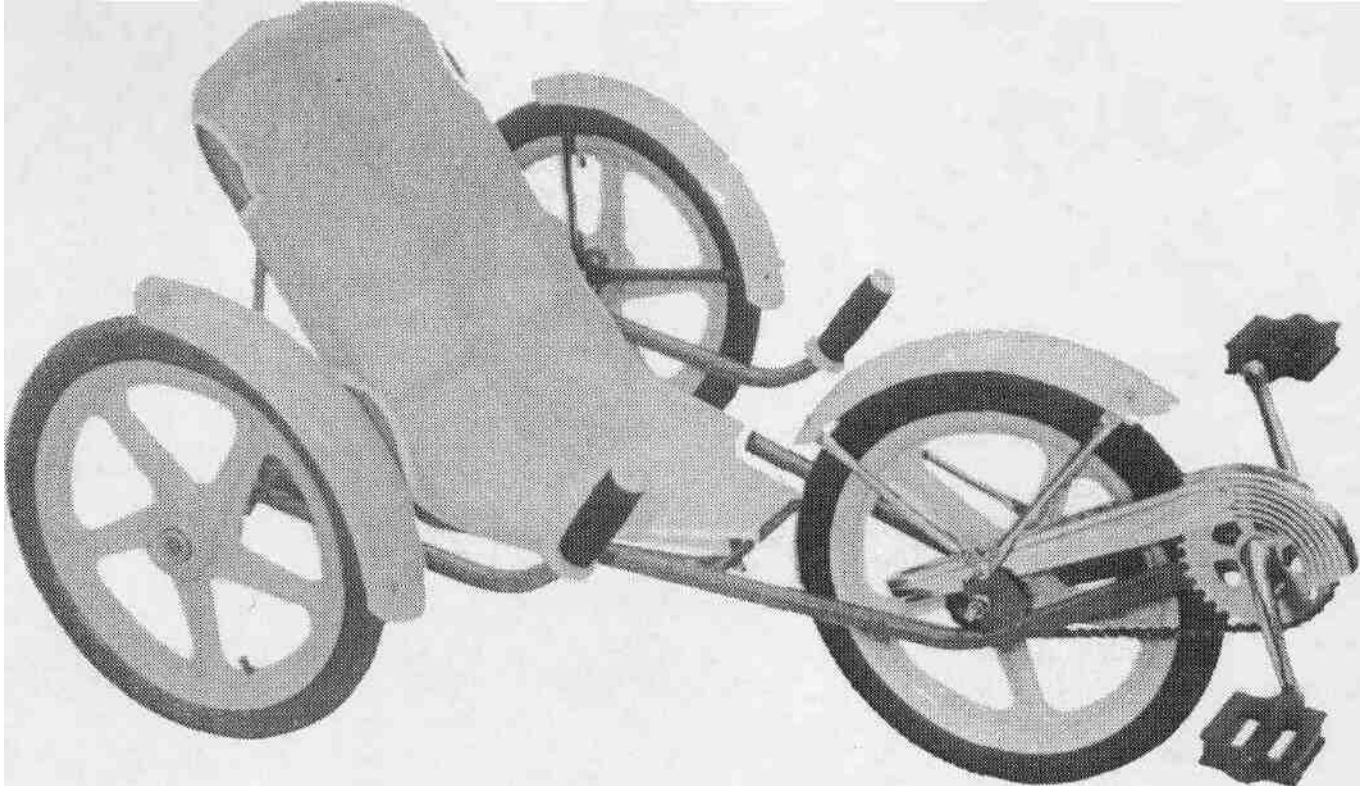

# BANANA PEEL



## OWNER'S GUIDE

#18840 4/98 \$1.00

ITEM #37 PART #19168 (1)  
NUT BRAKE STRAP



ITEM #5 PART #12170 (8)  
NUT #10-32 HEX



ITEM #1 PART #19171 (8)  
SCREW #10-32 X 3/8"



ITEM #7 PART #12428 (4)  
WASHER INTERNAL TOOTH



ITEM #25 PART #12172 (1)  
NUT #1/4-20



ITEM #22 PART #11065 (2)  
NUT #5/16-18 NYLON INSERT



ITEM #36 PART #19169 (1)  
SCREW #10-32 X 1/2" SCREW FOR BRAKE STRAP



ITEM #17 PART #13226 (2)  
WASHER THICKER ONE



ITEM #6 PART #12175 (2)  
NUT #5/16-18



ITEM #18 PART #13227(2)  
CLAMP NUT



ITEM #26 PART #12197 (1)  
SCREW #1/4-20 X 1/2"

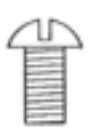

ITEM #21 PART #12236 (2)  
WASHER



ITEM #23 PART #19153 (2)  
NUT AXLE



ITEM #14 PART #12260 (2)  
SPRING

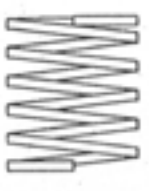

ITEM #4 PART #12210 (4)  
SCREW #5/16-18 X 1"

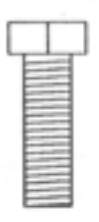

ITEM #24 PART #12301 (2)  
WASHER



ITEM #35 PART #12279 (1)  
CLAMP (BRAKE STRAP)



ITEM #11 PART #11070 (2)  
COTTER PIN



ITEM #12 PART #12240 (4)  
WASHER



# ILLUSTRATED PARTS LIST (BANANA PEEL)

# ILLUSTRATED PARTS BREAKDOWN

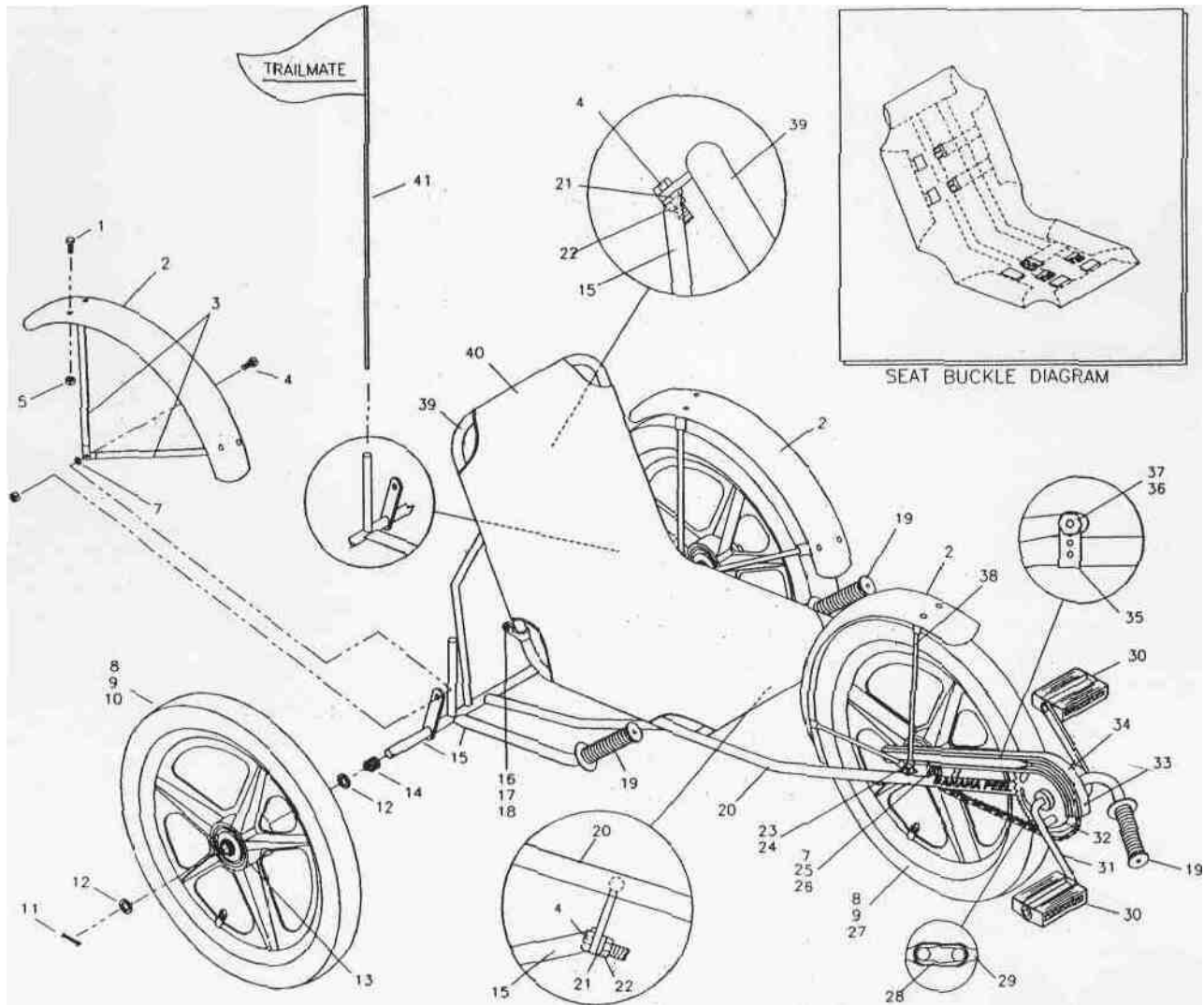

ITEM	PAR/Jff	DESCRIPTION	QTY.	ITEM	PART#	DESCRIPTION
1.	19171	SCREW #10-32 X 3/8 RHMS	8	22.	11065	NUT #5/16-18 NYLON INSERT
2.	12863	FENDER B/P 3	3	23.	19153	NUT AXLE CB SHIMANO
3.	18306	FENDER B/P BRACE 4	4	24.	12301	WASHER 3/8 FLAT SAE
4.	12210	SCREW #5/16-18 x 1 4	4	25.	12172	NUT #1/4-20 FLANGED
5.	12170	NUT #10-32 HEX KEPS 8	8	26.	12197	SCREW #1/4-20 x 1/2 RHMS
6.	12175	NUT #5/16-18 x 1 : ' . 2	2	27.	18785	WHEEL 16" MAG B/P w/CB
7.	12428	WASHER 3/8 INTERNAL TOOTH DRV.4	4	28.	11679	CONNECTING LINK
8.	11959	TIRE 16" x 1.75 BSW	3	29.	12934	CHAIN B/P 67 PITCH
9.	11973	TUBE 16" x 1.75	3	30.	11857	PEDAL 1/2" (PAIR)
10.	18787	WHEEL 16" MAG B/P w/ BEARING	2	31.	11694-	CRANK 4 1/2"
11.	11070	PIN COTTER 3/32 x 1	2	32.	11934	SPROCKET 36T
12.	12240	WASHER SPACER 1 x 41/64	4	33.	18832	CHAINGUARD B/P ASSEMBLY
13.	18120	BEARING 1-3/8 OD x 5/8 ID	4	34.	12188	SCREW #10-32 x 3/8 SLTD HWH
14.	12260	SPRING AXLE	2	35.	12279	CLAMP (BRAKE STRAP)
15.	18809	FRAME B/P REAR	1	36.	19169	SCREW BRAKE STRAP SHIMANO
16.	13225	CLMP BOLT M8 x 38mm LG HH	2	37.	19168	NUT BRAKE STRAP SHIMANO
17.	13226	CLMP WASHER M8 FLAT	2	38.	12864	FENDER BRACE 16" MWT
18.	13227	CLMP NUT M8 HEX	2	39.	18831	FRAME B/P BACKREST ASSEMBLY
19.	18175	GRIPS HANDLE YELLOW/BLACK	3	40.	19279	SEAT BANANA PEEL
20.	18808	FRAME B/P FRONT .	1	41.	12102	SAFETY FLAG w/o BRACKET
21.	12236	WASHER 5/16 SAE	2			

## 1. Preparation

Remove all parts from the carton. Do not remove protective wrapping until necessary. Open the parts bag and verify that all parts are present (refer to the illustrated parts list).

Check tire air pressure and inflate to 35 psi. Make sure tires are properly seated on rims.

## 2. Backrest

Install backrest (39) onto front frame assembly (20) with pivot mounting tube pointed downward and to the rear (see figure 1). The backrest should slide onto the frame 1 1/2" to 2" evenly on both sides. Note: This may be a tight fit and it may be necessary to lubricate the frame and tap the backrest with a rubber mallet.

Insert bolts (16) into backrest clamps from the outside and loosely install washers (17) and nuts (18). Note: On some backrest clamps it may be necessary to squeeze with pliers before inserting screws.

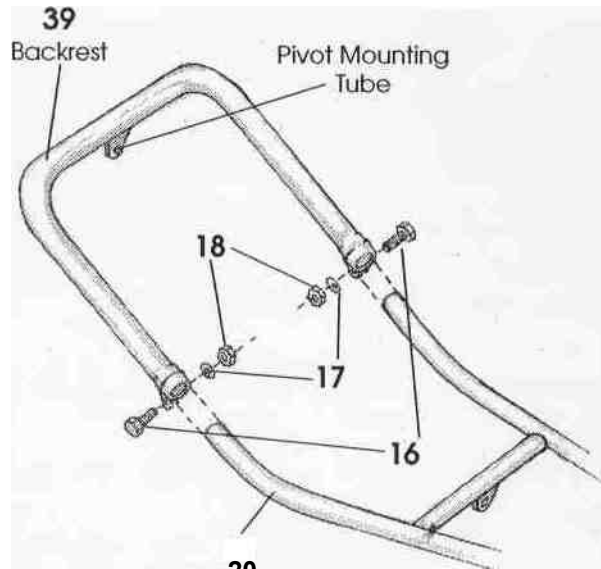

20  
Front Frame

## 3. Front and Rear Frame

Assemble front (20) and rear frame (15) sections together (see figure 2). Insert screws (4) into nylon bushings that are preassembled into frame sections. Secure with washers (21) and nuts (22). Tighten nuts so that the frame sections are securely held together, but not so much to cause binding when pivoted. Tighten backrest clamps and refer to schematics for correct placement.

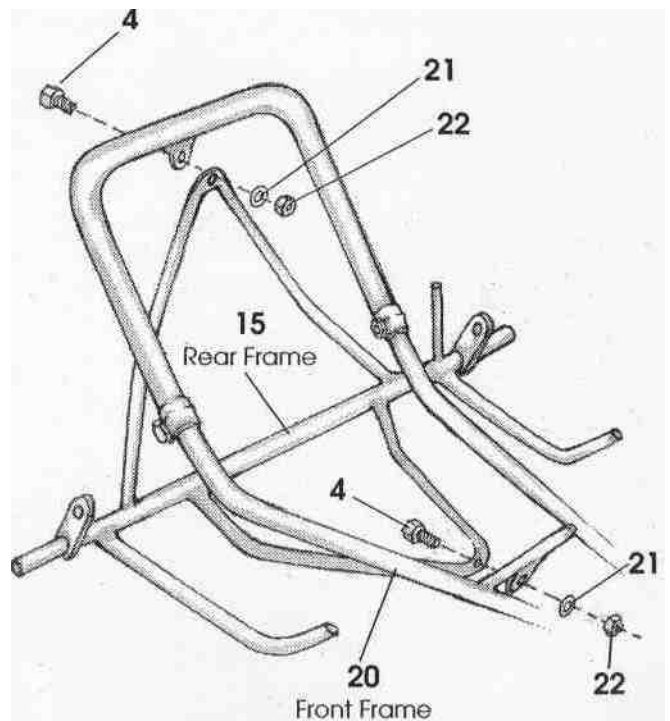

Fig. 2

#### 4. Front Wheel Assembly

Install front wheel assembly (27) between the frame wheelholders, with the brake lever pointing forward and above the left frame tube (see figure 3).

Install the front fender assembly (2) onto the front wheel axle (see fig. 4). Install washer (7) and fender braces onto axle. Note: Either the top or bottom brace may be installed first, but do the same for both sides. Install washers (24) and nuts (23), and loosely tighten.

#### 5. Brake Strap

Attach the brake strap (35) to the frame by bending it into a "U" shape and sliding it over the left frame tube, from the bottom up (see figure 4). Align the brake strap around the brake arm and insert screw (36) from the outside through the strap and arm. If necessary, use an awl to align all three holes. Secure with nut (37). Do not tighten until chain is adjusted.

#### 6. Chain

Place chain (29) around sprockets and join with connecting link (28) (see figure 5). Slide wheel assembly back until chain is tight (approximately 3/4" up and down movement is permissible). While holding wheel assembly centered between frame tubes, gradually tighten axle nuts alternately on each side. Tighten brake strap screw.

Crank the pedal sprocket and check for binding or "clicking" noise. If any is noticed, visually check the chain and sprocket alignment. Check that the sprockets do not rub on the frame tube and that the front tire is centered properly. If necessary, loosen brake strap screw and repeat steps 4 through 6.

#### 7. Pedals

Install pedals (30) by threading the pedal marked "R" into the right side of the crank (clockwise) and the pedal marked "L" into the left side of the crank (counterclockwise).

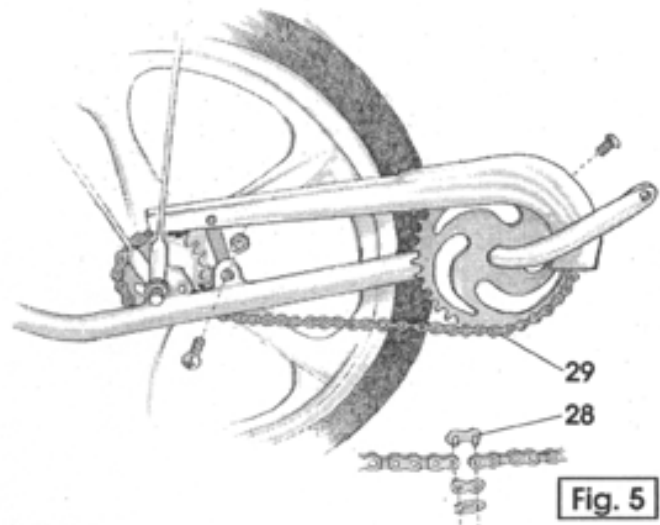
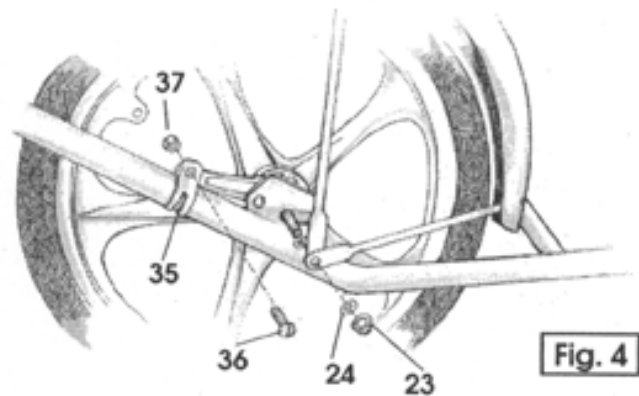
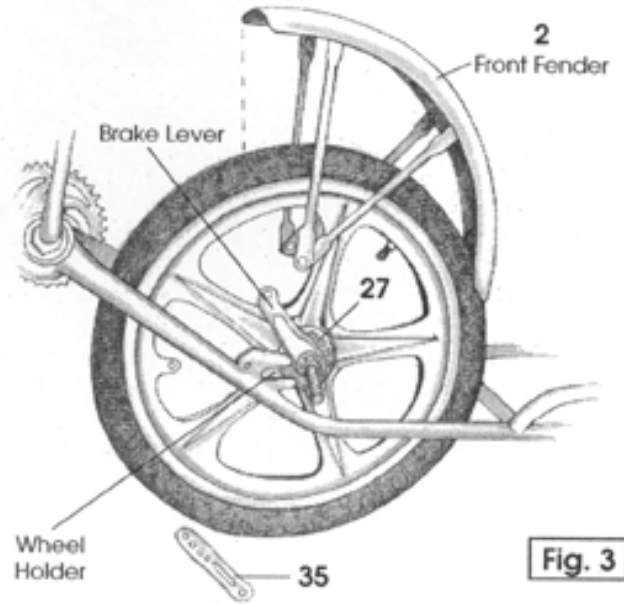

## 8. Chainguard

Install chainguard (33) by removing the screw (34) in the front mounting bracket (see figure 5). Place the rear of the chainguard between the wheel and fender brace. Align hole in rear of chainguard mounting bracket with the hole in the wheelholder tab. Make sure the chainguard is on the inside of the fender braces. Insert screw (26) from the outside and secure with nut (25). Pull chainguard forward until front chainguard mounting bracket hole lines up with the second hole in the front of the chainguard. Secure chainguard with screw (34). Carefully crank pedals and adjust as needed for clearance.

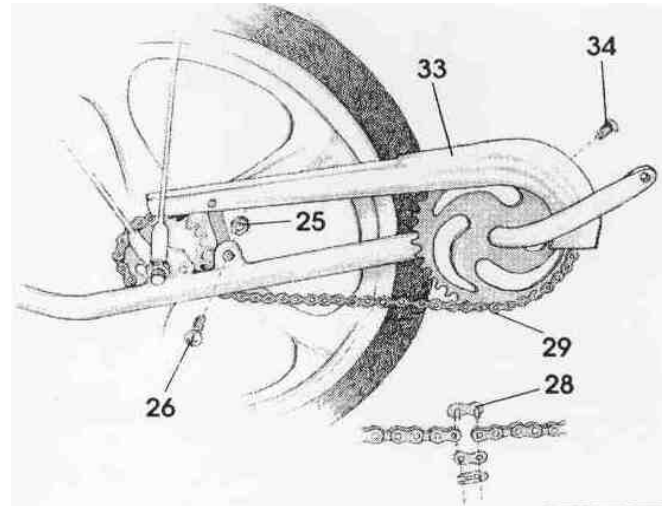

Fig. 5a

## 9. Rear Wheels

Slide rear axle springs (14) onto rear axles (see figure 6). Slide washer (12) onto axles, then slide on wheel and secure with washer (12) and cotter pin (11). NOTE: If wheel does not slide freely onto axle, lightly oil and try again. Do not force or pound wheel onto axle; this may damage the bearings in the hub.

## 10. Rear Fenders

Install rear fenders (2) to fender braces (3) with screws (1) and nuts (5) (see figure 6). Install washer (7) and rear fender braces (2) on fender brace holders and insert hex head capscrew (1) from the inside and secure with flange nut (5). Adjust fender position for clearance over tire and tighten. Refer to diagram for correct placement.

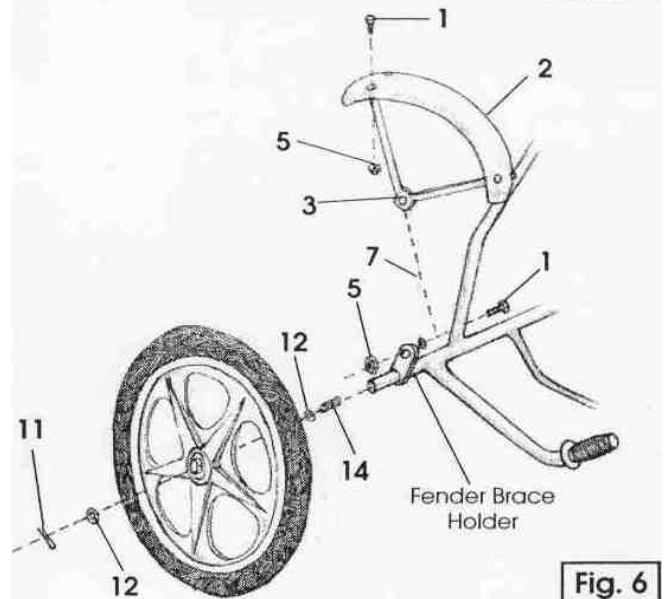

Fig. 6

## 11. All-Weather Canvas Seat

Place seat (40) on back rest, with the wide flap at top. Install flaps around outside frame and buckle from top to bottom and side to side (see figure 7). Sit in seat and readjust tension until comfortable.

## 12. Handgrips and Flag

Complete by installing handgrips (19) and placing safety flag (41) in holder.

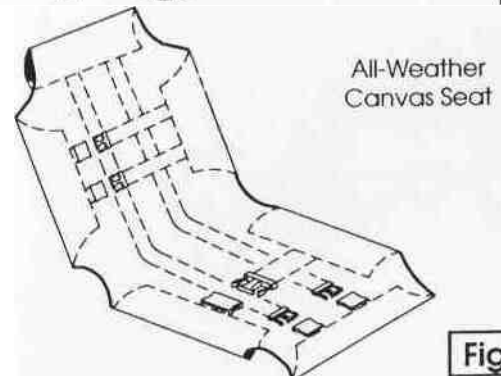

Fig. 7

# MAINTENANCE AND INSPECTION

## **REGULAR MAINTENANCE:** Bi-Monthly

1. Keep all painted parts cleaned and waxed for a long-lasting luster
2. Spray all chrome parts with recommended protective spray coating (LPS-1, WD-40, etc.). When spraying with protective coatings, it is recommended that you let parts set overnight so the coating will penetrate.
3. Lubricate the following:
  - Pivot points at top and bottom of seat
  - Axle shafts •
  - Inside bearings of both pedals
  - Chain - turn pedal crank forward and spray freely
4. When storing over prolonged periods, turn upside down to prevent flat spots from occurring on the tires. If stored outside, cover to protect finish and moving parts.

**PREVENTIVE MAINTENANCE:** Every Six Months These are services that should be performed by your local bicycle shop. A fee may be charged.

1. Check tires for wear, rim cuts and valve core alignment (usually caused by improper air pressure)
2. Check wheels for cracks and alignment.
3. Check brakes for proper operation
4. Clean and repack all bearings and adjust all cones
5. Check for worn bearings, cones and cups
6. Check chain for adjustment and clean as needed
7. Check for loose bolts and nuts.

Attention: While your unit is new, some noises may occur when the unit is breaking in. Should they continue for more than 30 days, see your local bike shop.

## **INSPECTION**

Check the following, as it applies to your cycle, on a regular basis:

1. Coaster Brake: Make sure the brake engages, by pedaling backwards.
2. Wheels: Check wheels for alignment.
3. Pedals: Inspect pedal bearings and make sure pedal is tightly attached to crank.
4. Handle Grips: Replace worn or loose grips.
5. Chain: Check for proper tightness. Replace damaged chain immediately.
6. Seat: Adjust seat for rider comfort and safety.
7. Tires: Keep tires inflated to the recommended tire pressure, as indicated on the tire's sidewall.
8. Chainguard; Replace damaged or missing chainguard immediately
9. Frame: Replace damaged frame immediately.



**TRAILMATE**

2359 Trailmate Drive  
Sarasota FL 34243  
(941)755-5511  
Fax:(941)758-5141

For service or to order  
replacement parts,  
please contact your  
local Trailmate dealer.

# BANANA PEEL

This is a recreational unit, not designed for excessive speeds or misuse. Careless operation may cause rider to lose control and result in serious injury.

Do not brake or turn at high speeds; this may cause cycle to roll-over and rider injury.

## Things to know before riding your cycle:

1. Know your local bicycle laws and wear a helmet
2. Do not exceed the recommended weight limit of 150 lbs
3. No more than one rider at one time
4. Do not stand on unit.
5. Be sure to install safety flags
6. Wear light-colored clothing and protective gear
7. Do not ride at night.

## Trailmate Limited Warranty

Trailmate, Inc., guarantees each cycle product against all defects in materials and workmanship for a period of 90 days from date of purchase. Tires and tubes are not covered by this guarantee.

During this period, any part that is judged by the makers to be defective will be replaced free of charge. Any failure resulting from accident, abuse, neglect, normal wear, or improper assembly or maintenance by the owner is not covered.

Trailmate, Inc., further authorizes a lifetime frame guarantee and will replace any frame, at no cost to the buyer, providing that item has not been used for rental use and that:

- 1) The item has not been altered, repaired, or modified in any way.
- 2) The item has not been subject to misuse, negligence, and/or an accident.
- 3) Original ownership is established.

Any parts under this guarantee on which claims are entered shall be returned for inspection with transportation charges prepaid by the claimant. Replacement parts will be shipped F.O.B. factory.

There are no warranties or guarantee, expressed or implied, written or oral, which extend beyond the description on the face hereof.

#18840 5/98

TRAILMATE owner's guide

