

# ILLUSTRATED PARTS BREAKDOWN

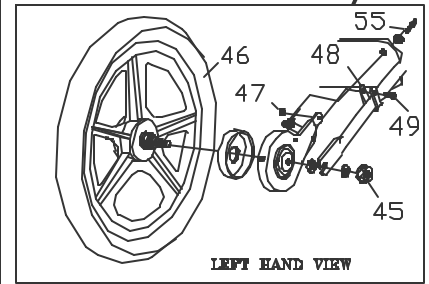
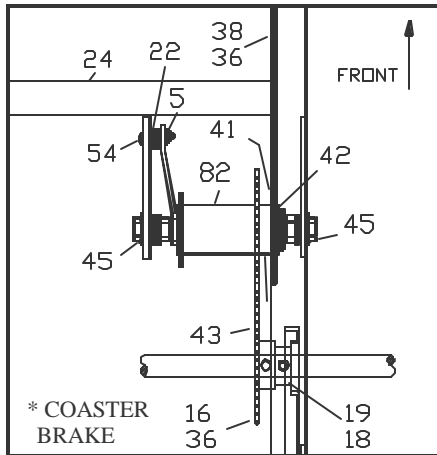
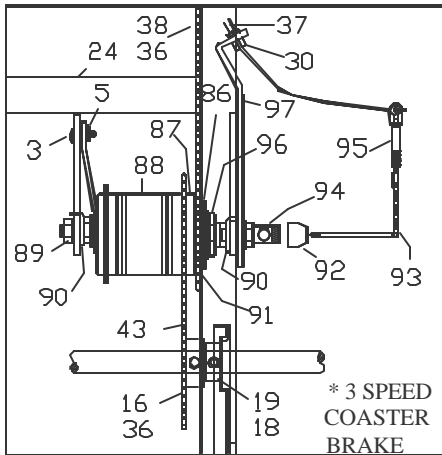
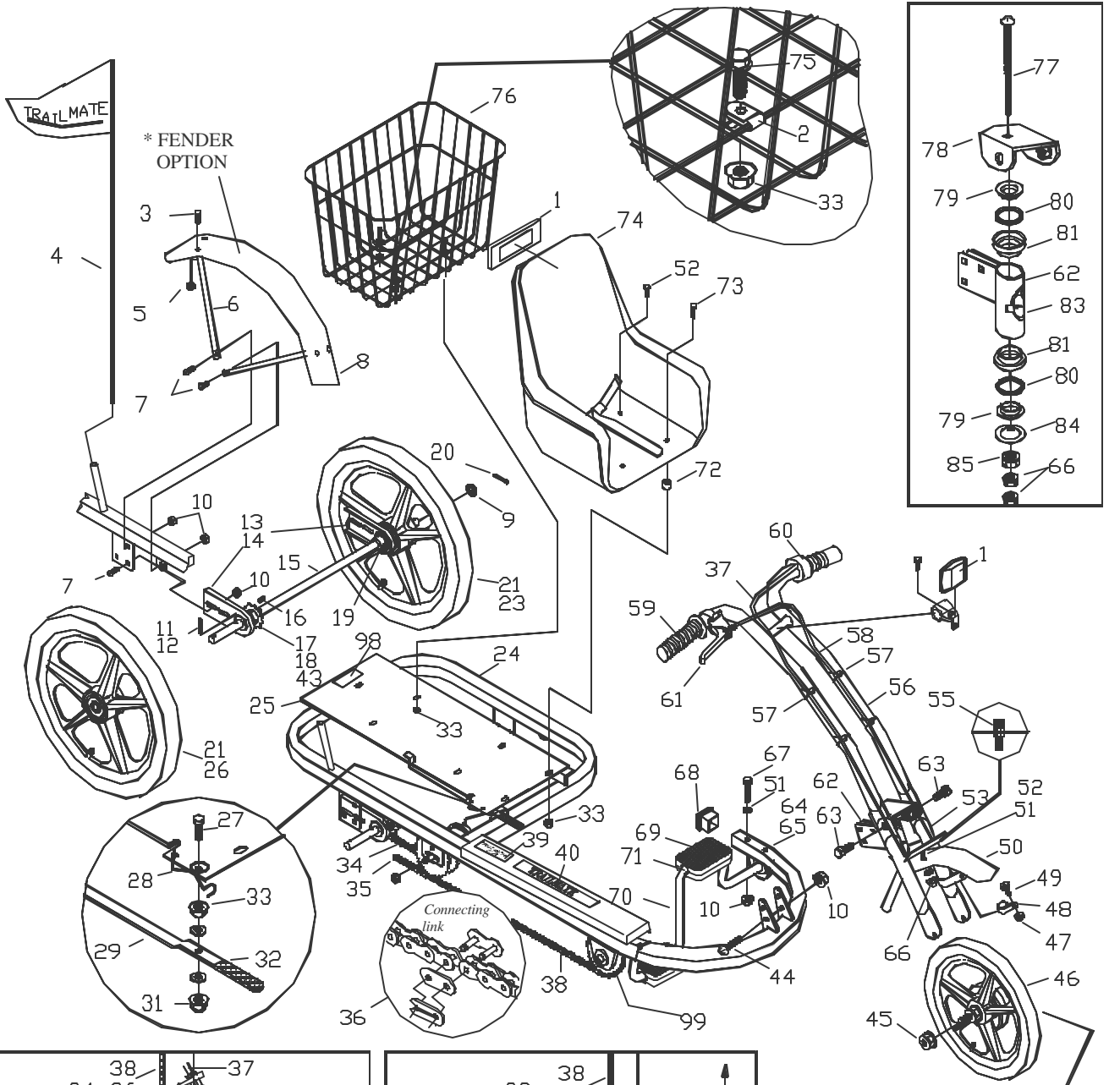

**\* OPTIONAL PARTS**

#17003

2/05/02



# Jr. Joyrider Assembly instruction

## 1. Preparation

Remove all parts from the carton. Do not remove protective wrapping until necessary.

Check tire air pressure and inflate to 35psi. Make sure tires are properly seated on rims.

## 2. Seat Assembly

Install seat Jr. Joyrider (74) to the base Jr. Joy seat/basket (25) using bolts (73), (52), spacers (72) and nut (33).

Be sure to tighten all nuts connecting.  
(see figure 1.)

Slide the seat & basket assembly over the frame rail and adjust the side lever for the operator's best leg and arm position  
(see figure 2.)

## 3. Handlebars

Remove two carriage bolts (44) and nuts (10) from the handlebar assembly. Insert the handlebar assembly into the two brackets at the front of the frame, and secure with the bolts (44) and nuts (10). Adjust the handlebar for the best position

*(handlebar should be tight but able to move forward and backward to allow for easy entry and exit).*

## 4. Handbrake

Before riding, roll the Jr. Joyrider back and forth and apply the brake lever. If the stopping action is not quick, tighten brake cable by loosening the nut on the bottom of the adjusting barrel (55) and turning the adjusting barrel clockwise (see figure 3). Once the braking action is firm, tighten the nut and adjusting barrel.

The brake lever may be set a parking brake by pulling back the brake lever, pushing down the spring loaded button, and releasing the lever; the button should stay in the pressed position. To return brake to its normal position, pull back brake lever – allowing the button to pop-up and release the lever.

## 5. Final Check

Complete by installing rear red and front clear reflectors on places (see figure 1. and Illustrated Parts Breakdown), safety flag (4) in the holder. Review the instruction, check connecting bolts and screws for tightness, and readjusting the seat and handlebar as necessary.

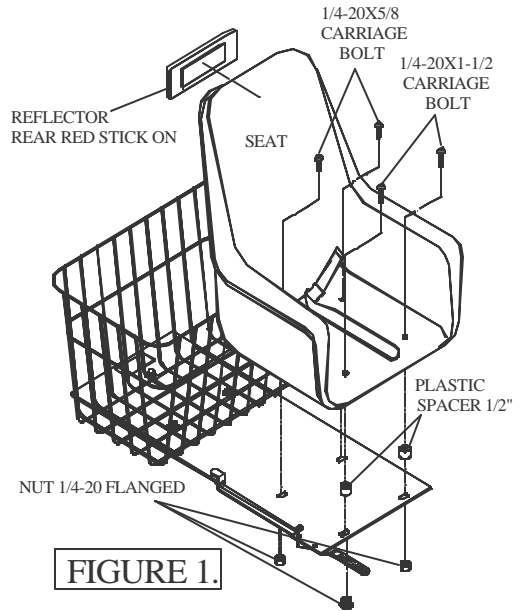

FIGURE 1.

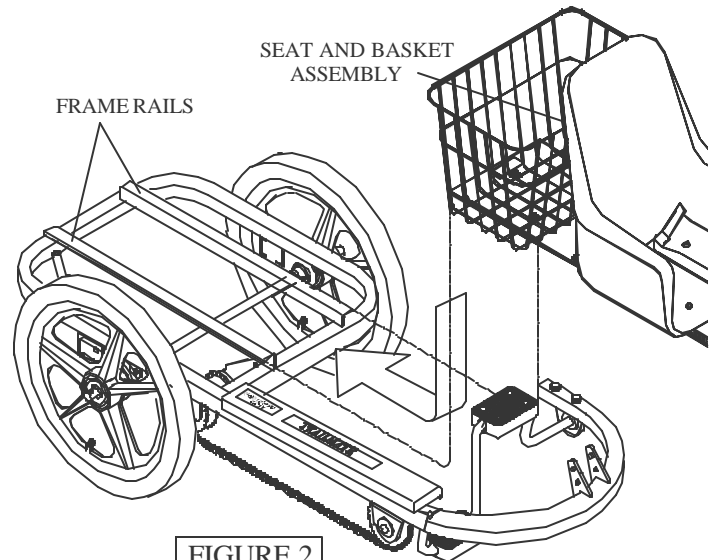

FIGURE 2.

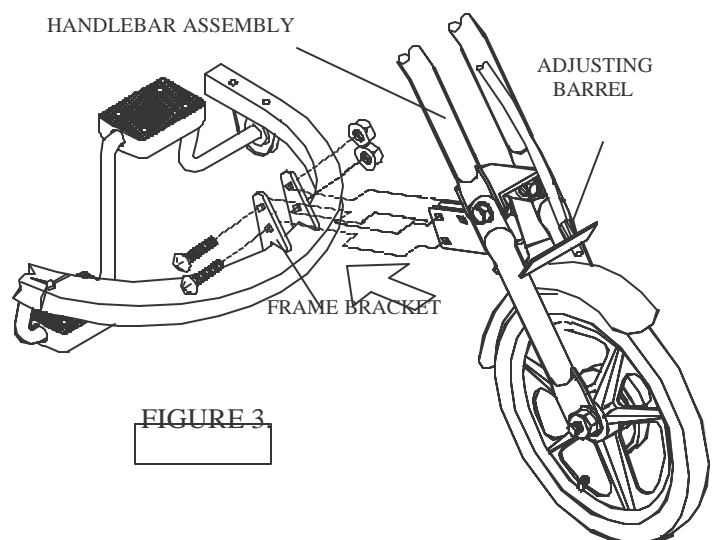

FIGURE 3.

# MAINTENANCE AND INSPECTION

---

## REGULAR MAINTENANCE: Bi-Monthly

1. Keep all painted parts cleaned and waxed for along-lasting luster.
2. Lubricate the following:
  - Axle shafts
  - Chain- turn pedal crank forward and spray freely.
3. When storing over prolonged periods, turn upside down to prevent flats from occurring on the tiers. If stored outside, cover to protect finish and moving parts.

---

## PREVENTIVE MAINTENANCE: Every Six Months

These are services that should be performed by you local bicycle shop. A fee may be charged.

1. Check tires for wear, rim cuts and valve core alignment (usually caused by improper air pressure)
2. Check wheels for cracks and alignment.
3. Check brakes for proper operation.
4. Check and repack all bearings and adjust all cones.
5. Check for worn bearings, cones and cups.
6. Check chain for adjustment and clean as needed.
7. Check for loose bolts and nuts.

Attention: While your unit is new, some noises may occur when the unit is breaking in. Should they continue for more than 30 days, see local bike shop.

---

## INSPECTION

Check the following, as it applies to your cycle, on a regular basis:

1. Hand Brake: Make sure the brake engages, by squeezing the hand brake.
2. Wheels: Check wheels for alignment.
3. Pedals: Inspect pedals and make sure pedals is tightly attached to crank.
4. Handle grips: Replace worn or loose grips.
5. Chain: Check for proper tightness. Replace damaged chain immediately.
6. Seat: Adjust seat for ride comfort and safety.
7. Tires: Keep tires inflated to the recommended tire pressure, as indicated on the tire's sidewall.
8. Frame: Replace damaged frame immediately.

***JR JOYRIDER INSTALLATION INSTRUCTIONS-COASTER BRAKE &***

***STURMEY-ARCHER 3-SPEED COASTER BRAKE (3SPCB) KITS.***

1. Remove rear right wheel from axle.
2. Remove rear axle from frame. Remove right side bearing holder. Remove freewheel and set collar. Install 22 T solid sprocket, with setscrew toward center of axle, and square key. Place set collar on axle next to sprocket. Reinstall bearing holder onto axle. Then install bearing holder, loosely to the frame. Slide set collar against bearing and secure in place. Align sprocket on axle with sprocket on hub and tighten in place. *NOTE:* Solid pins are being provided with coaster brake equipped trikes and coaster brake up grade kits. These pins *MUST* be used in place of the hollow roll pins that are provided for freewheel models. The solid pins will prevent wear to the hole in the axle and steel hub. This will eliminate chances of the pin becoming loose under hard usage.
3. Insert right side of hub axle, which has the sprockets mounted on it, through slot in bracket, which was used to secure rear of chain guard. Install five 3/8" washers onto left side of axle, to act as spacers. (Single Speed Coaster Brake Only) Slide left side of axle into open-ended slot of left axle holder. Keep washers on inside of axle holder. Loosely install axle nuts onto axle, *NOTE:* 3SPCB uses special bracket (IT.12) & special nut. Fasten brake arm of hub to left axle holder using a #10 screw 1" long, with a plastic spacer (C.B. only) use washers on 3SPCB and lock nut.
4. Place long chain provided with kit around crank sprocket and outer sprocket on hub. Join with connecting link. Pull hub back evenly until chain is tight, and then lock hub in place.
5. Install short chain around remaining hub sprocket and rear axle sprocket. Join with connecting link. Pull rear axle back evenly, until chain is tight and then lock bearing holders in place.
6. Check to make sure all nuts are tight and chain does not hit against guard. Assembly is now complete for Coaster Brake Model.

***THE FOLLOWING CONTINUED INSTRUCTIONS ARE FOR THE STURMEY-ARCHER 3SPCB***

7. Mount grip shifter (IT. 10) at left side of steering handle. Install plastic washer (IT. 1) and grip.
8. Screw indicator rod and chain (IT. 5) into hole in right end of axle. Install indicator plastic protector (IT. 6) over end of axle with indicator chain through it. Cable attachment screw (IT. 4) should point forward toward cable guide bracket (IT. 12).
9. Check that the indicator chain (IT. 5) runs freely through the indicator protector (IT. 6).
10. Fit plastic cable stop (IT. 11) to end of black shifter cable housing. Push cable stop (IT. 11) into hole in the front end of cable guide bracket (IT. 12).
11. Place grip shifter in #3 position. Carefully loosen nut on end of cable adjusting barrel (IT. 2) until cable hole is visible. Slide cable through hole (do not tighten yet). Screw adjusting barrel (IT. 2) onto indicator coupling (IT. 4) at end of chain (IT. 5). Pull all slackness out of cable, and clamp cable tightly with pinch bolt (be careful not to over-tighten bolt as it can break).
12. Place shifter into 2<sup>nd</sup> gear position on gear control. Looking through the "window" in the right hand axle nut (IT. 9) turn the cable adjuster (IT. 2) until the end of indicator rod (IT. 5) is exactly level with the end of the axle (IT. 7). Tighten the lock nut (IT. 3) against the adjuster (IT. 2).
13. If correct adjustment cannot be made then the cable must be moved in pinch bolt in the appropriate direction.