



LOW RIDER



OWNER'S GUIDE

#18550 3/99 \$1.00

LOW RIDER PARTS LIST

ITEM;?	PARTJC	DESCRIPTION	QTY.	.ITEM^	PART,?	DESCRIPTION	QTY.
1.	12102	SAFETY FLAG w/o BRKT.	1	36.	13876	WHL 16"x2.125 MAG LR W/BB	1
2.	12201	SCREW 1/4x3/8 HW HD #B	3	37.	11718	DECAL-TM HEAD	1
3.	17779	REFLECTOR KIT, LOW RIDER	1	38.	1 2269	TIE CABLE, BLACK	2
4.	11958	TIRE, 20x2.125 BSW KNBY	2	39.	18538	STRUT ASSEMBLY LOW RIDER, S.C.	1
5.	11972	TUBE, 20x2.125 LR/DD	2	40.	11831	HEAD SET, COMPLETE	1
6.	17986	WHL 20x1.75 MAG LR BLK	2	41.	11815	STEM 12" LOW RIDER	1
7.	17240	FRAME, LR REAR, STATE COLOR	1	42.	12238	WASHER 3/8 USS	3
8.	11643	BEARING SP <(499502H	2	43.	11 626	AXLE, NON-DRIVE	1
9.	15198	SCREW GROMMET PLASTIC	1	44.	11605	NUT 5/16-18 NYLON INSERT	1
10.	12218	SCREW 3/8-16x5/4 SHT	2	45.	12242	PLUG TUBE, 1-1/4 SQ. REGAL	
11.	11642	BEARING AXLE, 5/8ASF 107E	2	46.	12175	NUT 5/16-18 FLANGED (REF)	3
12.	12178	NUT 3/8-16 FLANGED	2	47.	16699	SCREW 1/4-20x5/8 HW HD B	2
13.	12241	SET COLLAR 5/8	2	48.	18554	SEAT FRAME, LOW RIDER, ST. CLR.1	
14.	12246	KEY, SQUARE 3/16x5/8	1	49.	18522	CLAMP LR SEAT OK RLS LC-420	1
15.	11627	AXLE, DRIVE	1	50.	12213	SCREW 5/16-18x2 HHCS	1
16.	18860	PIN GROOVE, 3/16x1/4 AL.	2	51.	18590	BRAKE LEVER LOW RIDER	1
17.	12229	WASHER, #10 FLAT	4	52.	17778	CABLE ASSY. 46.5x55.5	1
18.	18714	SCREW 8x1/2 #A HX WSH HD	1	53.	11805	HANDLEBAR, HI RISE	1
19.	18541	CHAINGUARD, LOW RIDER, ST.CLR. 1		54.	1 1801	GRIP BLACK 7/8	2
20.	11719	DECAL-TM CHAINGUARD	1	55.	1 1894	SEAT WESTERN SADDLE	1
21.	14089	DECAL-AVOID SHARP TURNS	1	56.	18521	BACK REST PAD LOW RIDER	1
22.	19153	NUT CB SHIMANO	2	57.	1 6960	HUB CB DUST RING SHIMANO.	1
23.	17239	FRAME, LR MAIN, STATE COLOR	1	58.	11667	HUB CB TRIKE SHIMANO	1
24.	19113	CHAIN LR 153 PITCH 1/2x1/8	1	59.	11939	SPROCKET 21T CB SHIM.	1
25.	11679	CHAIN CONNECTING LINK	2	60.	16961	HUB CB SNAP RING SHIMANO	1
26.	11695	CRANK 5-1/2	1	61.	1 1684	CHAIN CB/3SPCB 37 PITCH	1
27.	11934	SPROCKET 36T 1/2x1/8	1	62.	12240	WASHER SPACER	6
28.	11697	CRANK SET, COMPLETE	1	63.	11066	SET SCREW 5/16-18x5/16	2
29.	18577	HEAD CUP ^401 B STEAKED LR	2	64.	11952	SPROCKET 22T SOLID W/HUB	t
30.	11857	PEDAL 1/2" PR^643P10E141	1	65.	12170	NUT 10-32 HEX KEPS	2
31.	17851	ADJ. BARREL^AND NUT BB	1	66.	12193	SCREW 10-32x1 PHIL PAN	1
32.	18553	FORK ASSEMBLY. LOW RIDER, S.C.I		67.	18804	BAND BRAKE (BB) ASSY. (REF)	
33.	19002	NUT 3/8x24 FLANGED	2	68.	13888	NUT 3/8-24 JAM (REF) ,	
34.	17615	TIRE, 16x2.125 BSW KNBY	1	69.	12279	CLAMP (BRAKE STRAP)	1
35.	17614	TUBE. 16x2.125 LR/DD	1	70.	12191	SCREW 10-32x1/2 HEX)

Low Rider Assembly Instructions

1. Preparation

Remove all parts from the carton. Do not remove protective wrapping until necessary. Open the parts bag and verify that all parts are present (refer to the illustrated parts list, back page).

Check tire air pressure and inflate to 35 psi. Make sure tires are properly seated on rims.

(cycle upside down)

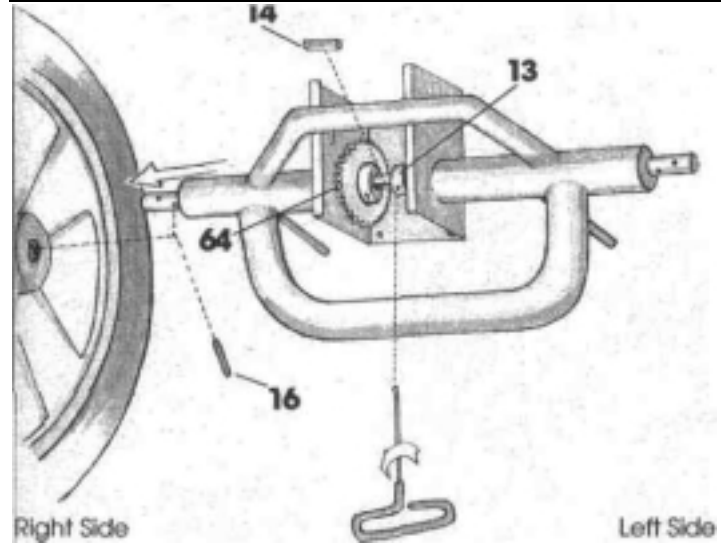

2. Rear Frame and Wheels

Turn upside down, and on the left rear axle (non-drive), loosen the set collar (13) and pull axle (43) outward (see figure 1). Insert the axle into the wheel (6) and secure with groove pin (16) using the inside hole on axle. Note: The wheel collar should face the inside of the trike. Reinsert axle into frame, with the wheel up against the frame. Reinstall set collar and tighten. Repeat for right side, making sure the key square (14), sprocket (64) and spacers (62) are up against the frame; these parts may become detached when removing axle, correctly reinstall (see schematic).

Fig.1

3. Frame Assembly

(For 3-speed, see instructions enclosed in frame carton.) Unscrew the nuts (22) holding the CB hub in place and slide the rear frame assembly onto the front frame assembly (see figure 2). The frame should slide completely forward with the axle of the CB hub between the front and rear frames, and the brake arm pointing back. Install 3/8" carriage bolts (10) inward through the slots in the rear, making sure the square shoulders of the bolt fit into the slot. Install flange nuts (12), but do not tighten at this time.

(cycle upside down)

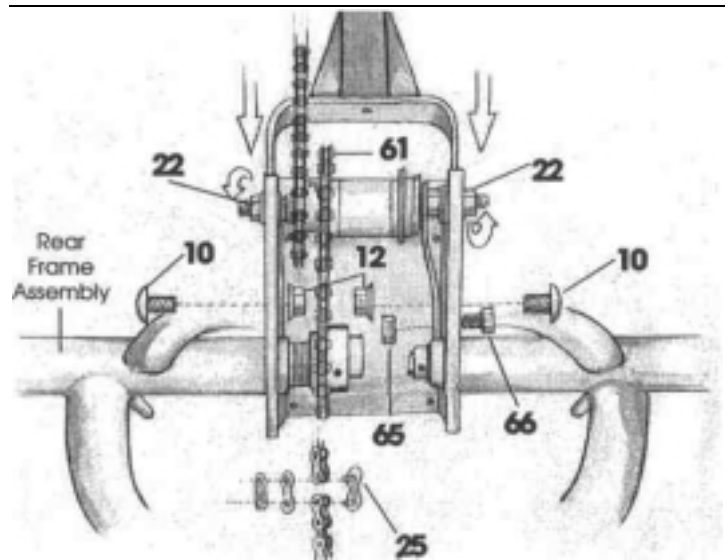

4. Chain

Place chain (61) around drive sprocket (64) and CB sprocket, joining with connecting link (25) (see figure 2). Slide the frame sections apart until both chains are tight (approximately 3/4" up and down movement is permissible). To secure brake arm, locate hole on left side of rear frame and install screw (66). Use washers (17) to fill space between frame and brake arm, and secure with nut (65). Make sure the CB hub and frames are centered and securely tighten all nuts. Turn the crank and check for binding or "clicking" noise. If any noise is noticed, the chain may need to be loosened until the binding is eliminated.

Right Side

Left Side

Fig. 2

5. Front Wheel

Place the front wheel (36) into the front fork with the band brake on the left side and on top of fork tube (see figure 3). Position the front struts (39) over the axle, center wheel in the fork assembly, and secure axle nuts (33).

6. Front Brake Strap

Attach the brake strap (69) to the frame by bending it into a "U" shape and sliding it over the left side of fork, from the bottom up (see figure 3). Align the brake strap around the brake arm and insert screw (70) from the outside through the strap and arm. If necessary, rebend the brake strap and use an awl to align all three holes. Secure with nut (65).

7. Chainguard

Remove the screw (2) from the chainguard mounting bracket, located above the crank on the front frame (see figure 4). Insert the plastic screw grommet (9) into the rear frame section, as indicated in diagram. The slot in the back of grommet should be parallel with frame slot, so it will lock in place. Place the chainguard over the chainguard mounting bracket and on top of the rear frame. Align the holes at the front of the chainguard and secure with screw (2) previously removed. Line up the plastic grommet with the hole at the rear of the chainguard and secure with washer (17) and screw (18). Note: it may be necessary to move the plastic grommet forward or backwards in order to correctly line it up with the hole.

8. Backrest and Western Saddle Seat

Secure the backrest (56) to the seat back using two hex head screws (47) (see figure 4). To install the western saddle seat (55), remove the nuts (45) from the bottom of the seat. Place the studs of the seat into the holes on the seat frame and secure with the nuts previously removed.

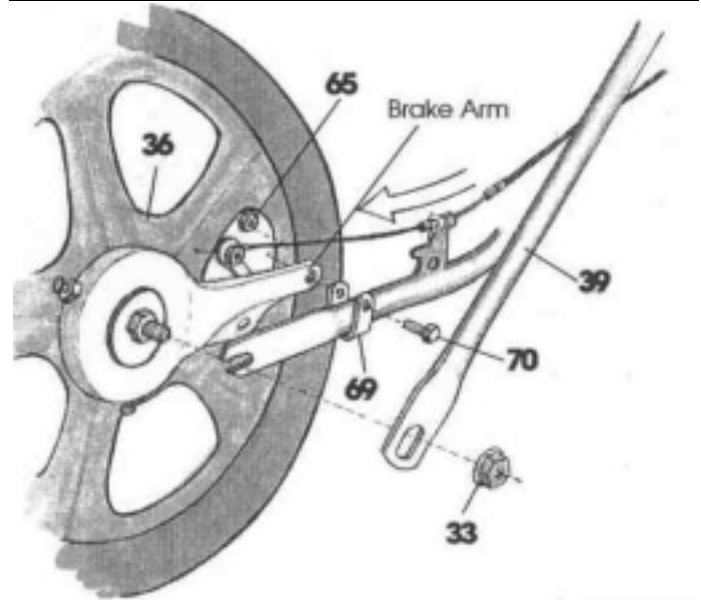

Fig. 3

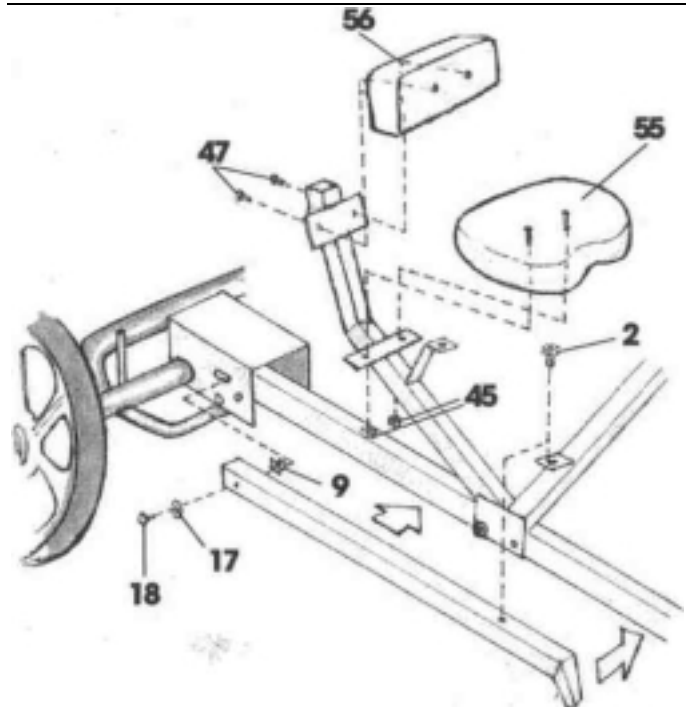

Fig. 4

Low Rider Assembly Instructions

9. Handlebar

Place the handlebar (53) through the clamp on the stem (41), with the long bolt on stem to the rear of the handlebar (see figure 5). Attach the front clear reflector to the bracket found in the reflector bag. Remove clamp nut and washer from front bolt of stem and install reflector assembly. Reinstall washer and tighten clamp nut. Place stem into fork until the line marked on the stem is no longer visible. Align the handlebar to the fork, facing straight ahead, and tighten bolt in stem firmly. Do not over tighten as this may damage the fork tube. Position handlebars to a comfortable position, tighten clamp nut.

10. Brake Lever

Slide the handbrake lever (51) on the right side of the handlebar and lightly tighten, leaving room to install handle grips (see figure 5). Place the brake cable (52), side with the stud, into the handbrake. Thread the other end of the brake cable through both the adjusting barrel (31) and the hole in the screw (65), on the band brake lever (see figure 6). It will be necessary to loosen screw to locate hole. Pull back lever on band brake to engage brake, making sure cable is tight, and tighten screw (65). Squeeze hand brake several times and check brake adjustment. If brake does not engage, loosen screw on band brake lever, pull hand brake lever back, tighten cable and retighten screw. Brake cable will stretch after several times of use and may need to be readjusted.

11. Pedals

Install pedals (30) by threading the pedal marked "R" into the right side of the crank (clockwise) and the pedal marked "L" into the left side of the crank (counterclockwise).

12. Reflectors

Insert the screw, provided with the red reflector, through the bracket and thread into the back of the reflector. The inside arch of the clip should face the seat. Install the reflector to the top of the rear frame and secure with a self tapping screw (2). Repeat for other side. Refer to schematic for correct position.

13. Final Check

Complete by installing handle grips (54) and installing safety flag (1) in the holder. Review the instructions, check connecting bolts and screws for tightness, and readjust the seat and handlebar as necessary.

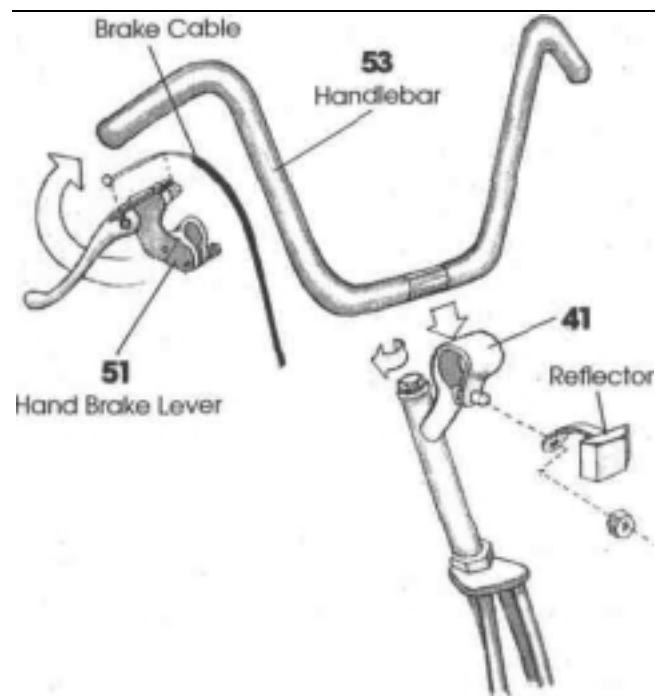

Fig. 5

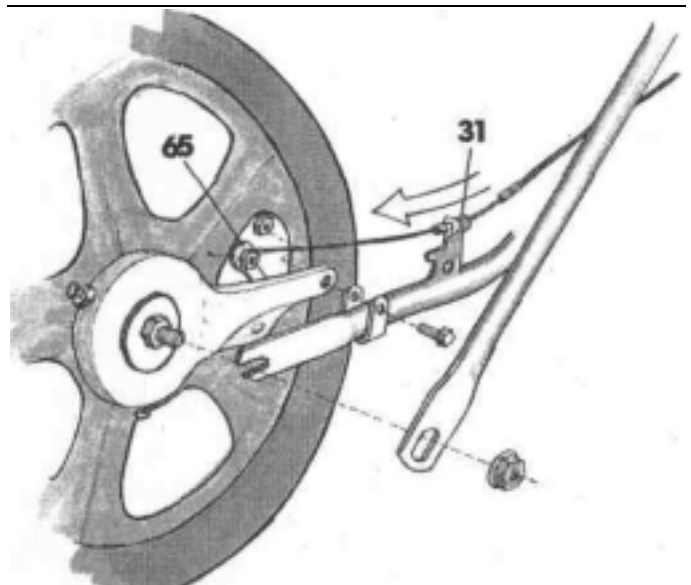

Fig. 6

MAINTENANCE AND INSPECTION

REGULAR MAINTENANCE: Bi-Monthly

1. Keep all painted parts cleaned and waxed for a long-lasting luster
2. Spray all chrome parts with recommended protective spray coating (LPS-1, WD-40, etc.). When spraying with protective coatings, it is recommended that you let parts set overnight so the coating will penetrate.
3. Lubricate the following:
 - Axle shafts
 - Inside bearings of both pedals
 - Chain - turn pedal crank forward and spray freely
4. When storing over prolonged periods, turn upside down to prevent flat spots from occurring on the tires. If stored outside, cover to protect finish and moving parts.

PREVENTIVE MAINTENANCE: Every Six Months These are services that should be performed

by your local bicycle shop. A fee may be charged.

1. Check tires for wear, rim cuts and valve core alignment (usually caused by improper air pressure)
2. Check wheels for cracks and alignment.
3. Check brakes for proper operation
4. Clean and repack all bearings and adjust all cones
5. Check for worn bearings, cones and cups
6. Check chain for adjustment and clean as needed
7. Check for loose bolts and nuts.

Attention: While your unit is new, some noises may occur when the unit is breaking in. Should they continue for more than 30 days, see you local bike shop.

INSPECTION

Check the following, as it applies to your cycle, on a regular basis:

1. Coaster Brake: Make sure the brake engages, by pedaling backwards.
2. Wheels: Check wheels for alignment.
3. Pedals: Inspect pedal bearings and make sure pedal is tightly attached to crank.
4. Handle Grips: Replace worn or loose grips.
5. Chain: Check for proper tightness. Replace damaged chain immediately.
6. Seat: Adjust seat for rider comfort and safety.
7. Tires: Keep tires inflated to the recommended tire pressure, as indicated on the tire's sidewall.
8. Reflectors: Replace missing reflectors immediately.
9. Chainguard: Replace damaged or missing chainguard immediately
10. Frame: Replace damaged frame immediately.



TRAILMATE

2359 Trailmate Drive
Sarasota FL 34243
(941)755-5511 Fax:
(941) 758-5141

For service or to order
replacement parts,
please contact your
local Trailmate dealer.

LOW RIDER

This is a recreational unit, not designed for excessive speeds or misuse. Careless operation may cause rider to lose control and result in serious injury.

Do not brake or turn at high speeds; this may cause cycle to roll-over and rider injury.

Things to know before riding your cycle:

1. Know your local bicycle laws and wear a helmet
2. Do not exceed the recommended weight limit of 250 lbs
3. No more than one rider at one time
4. Do not stand on unit.
5. Be sure to install safety flags
6. Wear light-colored clothing and protective gear
7. Do not ride at night.

Trailmate Limited Warranty

Trailmate, Inc., guarantees each cycle product against all defects in materials and workmanship for a period of 90 days from date of purchase. Tires and tubes are not covered by this guarantee.

During this period, any part that is judged by the makers to be defective will be replaced free of charge. Any failure resulting from accident, abuse, neglect, normal wear, or improper assembly or maintenance by the owner is not covered.

Trailmate, Inc., further authorizes a lifetime frame guarantee and will replace any frame, at no cost to the buyer, providing that item has not been used for rental use and that:

- 1) The item has not been altered, repaired, or modified in any way.
- 2) The item has not been subject to misuse, negligence, and/or an accident.
- 3) Original ownership is established.

Any parts under this guarantee on which claims are entered shall be returned for inspection with transportation charges prepaid by the claimant. Replacement parts will be shipped F.O.B. factory.

There are no warranties or guarantee, expressed or implied, written or oral, which extend beyond the description on the face hereof.

#18550 3/99 ^

TRAILMATE owner's guide

Cruising Speed.



Low Rider and Fun Cycle

TRAILMATE owner's guide

#18 ITEM 18714 (1)
SCREW 8 X 1/2 HX



#70 ITEM 12191 (1)
SCREW 10-32 X 1/2 HEX



#66 ITEM 12193 (1)
SCREW 10-32 X 1" PHIL PAN



#2 ITEM 12201 (2)
SCREW 1/4 X 3/8 HW



#47 ITEM 16699 (2)
SCREW 1/4-20 X 5/8



#10 ITEM 12218 (2)
SCREW 3/8-16 X 3/4 SHT

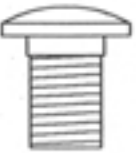

#65 ITEM 12170 (2)
NUT 10-32 HEX



#12 ITEM 12178 (2)
NUT 3/8-16



#33 ITEM 19002 (2)
NUT 3/8-24



#17 ITEM 12229 (4)
WASHER, 10 FLAT



#9 ITEM 13198 (1)
SCREW GROMMET PLASTIC



#16 ITEM 18860 (2)
PIN GROOVE, 3/16 X 1 1/4 AL.



#69 ITEM 12279 (1)
CLAMP (BRAKE STRAP)



ILLUSTRATED PARTS LIST (LOW RIDER)